



SIZE	RUN-IN	SHED ROW
	SHEDS	Stall/Tack Room
		
10x10	\$4,660.00	\$5,745.00
10x12	\$4,985.00	\$6,085.00
10x14	\$5,310.00	\$6,415.00
10x16	\$5,625.00	\$7,790.00
10x18	\$5,955.00	\$8,380.00
10x20	\$6,460.00	\$8,925.00
10x22	\$6,705.00	\$9,205.00
10x24	\$7,175.00	\$9,810.00
10x26	\$7,640.00	\$11,520.00
10x28	\$8,145.00	\$12,060.00
10x30	\$8,630.00	\$12,480.00
10x32	\$9,105.00	\$12,625.00
10x34	\$9,590.00	\$13,155.00
10x36	\$10,340.00	\$13,505.00
10x38	Ask for price	\$15,005.00
10x40	\$11,055.00	\$15,905.00
10x42	Ask for price	\$16,630.00
10x44	Ask for price	\$17,360.00
10x46	Ask for price	\$17,610.00
10x48	\$12,975.00	\$18,180.00
12x12	\$5,920.00	\$7,040.00
12x14	\$6,245.00	\$7,670.00
12x16	\$6,570.00	\$8,730.00
12x18	\$7,140.00	\$9,340.00
12x20	\$7,725.00	\$10,380.00
12x22	\$8,280.00	\$10,825.00
12x24	\$8,875.00	\$11,630.00
12x26	\$9,480.00	\$12,975.00
12x28	\$10,060.00	\$13,625.00
12x30	\$10,600.00	\$14,195.00
12x32	\$11,225.00	\$14,835.00
12x34	\$11,795.00	\$15,655.00
12x36	\$12,340.00	\$16,465.00
12x38	Ask for price	\$17,275.00
12x40	\$13,525.00	\$18,075.00
12x42	Ask for price	\$18,910.00
12x44	Ask for price	\$19,710.00
12x46	Ask for price	\$20,515.00
12x48	\$15,860.00	\$21,335.00

# Combo Horse Barns

## Run-In / Stall / Tack Room



**Upgrade to  
LP SmartSide  
Siding**

**Add 5%  
to base price**

**INCLUDES:**  
\* Painted siding  
\* OSB on top of  
kickboard to  
top plate  
\* Aluminum  
window(s)  
vs. wood

**Paint Siding  
Add 10%**

**Urethane Stain  
On Siding  
Add 22%**

**Paint Trim:**  
Corner Trim: \$165  
Door Trim: \$80/ea.  
Fascia Trim: \$165  
Window/Vent Trim: \$35

### STANDARD FEATURES:

- 6x6 Pressure treated base rail
- Rough sawn oak framing
- Rough sawn pine board & batten siding
- 18" Overhang
- 4' Oak kick boards in stall and run-in part
- 4'x7' Dutch door in stall
- Lifetime warranty architectural shingle
- No stain or paint on exterior (optional)
- Window in stall and tack room; None in run-in (optional)
- Tack room has full floor and service door

### To Figure Price:

**Shed Row barns include multiple horse stalls and tack rooms.** It is possible to combine a run-in and a shed row barn. **Simply add the two prices together.**  
Example: 12x36 Barn with a 12x12 run-in, 12x12 stall, and 12x12 tack room would be a 12x12 run-in price and 12x24 shed row price minus the combination discount.

**COMBINATION DISCOUNT:**  
10' wide barns: \$1,000.00  
12' wide barns: \$1,500.00

\$5,920.00 - 12x12 Run-In  
\$11,630.00 - 12x24 Shed Row Barn  
 \$17,550.00 - SUBTOTAL  
-\$1,500.00 - Combination discount  
**\$16,050.00 - TOTAL**



**Carolina  
Storage  
Solutions**

[www.DeliveredBarnsAndSheds.com](http://www.DeliveredBarnsAndSheds.com)

## RUN-IN SHEDS, SHED ROW BARNs, & STORAGE SHEDS OPTIONS

ROOF OPTIONS	COST	EXTRA WINDOWS	COST
15 lbs. felt roof underlayment-per sq ft	\$0.95	Shutters- wooden with Z brace- (2) per window	\$180.00
Ice & Water Sheild roof underlayment- per square ft of roof	\$1.85	Window -Service Door with Thermal Tempered Glass - per window	\$255.00
29 Ga. Metal roof w/double bubble insulation-instead of std shingle roof-per sq fto of roof	\$4.45	Window -Dutch Door with Thermal Tempered Glass and grill-per window	\$475.00
Upgrade 1/2" Plywood instead of std OSB -per sq ft of roof	\$0.65	28"x24" 6 Lite Wood Barn Sash Window	\$160.00
Custom Roof Colors and Brands - call for quote		28"x24" 6 Lite Wood Barn Sash Window w/grill-per window	\$470.00
Custom Paint or Stain Colors or Brands add 20% to base price		5' & 6' Transom Window in or above Storage Shed Doors	\$165.00
Gable Vent- 19"x28" overall, screened vented area 12"x22"	\$180.00	10"x29" Transom Window in Service Door	\$110.00
Ridge Vent- per lineal ft	\$9.50	Drop Vent- 24"x36" hinged on bottom	\$225.00
<b>KICK BOARD</b>		<b>CUPOLA</b>	
Kickboard Southern Yellow Pine 2x8 T&G 4' high in stall upgrade per sq ft of stall	\$3.20	B-20 Boston Series	\$675.00
Kickboard Southern Yellow Pine 2x8 T&G 8' high in stall upgrade per sq ft of stall	\$7.00	B-24 Boston Series	\$910.00
		Weather Vane-Patchen Horse (Polished)	\$500.00
<b>PARTITION ADDED RUN IN SHED</b>		Cupola-Screened on inside of louvers-per cupola	\$115.00
Partition Addition-8' wide with grill or optinal removable partition with 2x8 T&G 7' high	\$635.00	Cupola-Chimney vented & flashed-Check for price	
Partition addition-10' Wide Grill Partition or optional removable Partition with 2x8 T&G 7' high	\$795.00		
Partition Addition-12' Wide Grill Partition or optional Removable Partition with 2x8 T&G 7' high	\$955.00	<b>STORAGE SHED DOORS</b>	
Grill Mounted Hay Rack & Feed Hole in Grill	\$215.00	Wider Doors 6' Wide-height may vary per style of building	\$65.00
3' Wall Mounted Hayrack	\$180.00	Wider Doors 8' Wide-height may vary per style of building	\$100.00
8' Wire-Filled Horse Gate w/ Lockable Latch	\$425.00		
		<b>STORAGE ROOM FLOOR</b>	
<b>STORAGE ROOM RUN IN SHED</b>		Sq. Ft. of Floor-Floor Joist @ 12" O.C.	\$1.05
Storage Room- Run In Shed-8' wide	\$1,245.00	Sq. Ft. of Floor-Floor Joist @ 8" O.C.	\$1.50
Storage Room-Run In Shed-10' Wide	\$1,405.00	Sq. Ft. of Floor-Upgrade-Pressure Treated Plywood or Advantech	\$1.30
Storage Room-Run In Shed-12' Wide	\$1,565.00		
		<b>CHEW GUARDS</b>	
<b>OTHER OPTIONS</b>		Chew Guard For 10' Stall	\$535.00
Lineal Ft.-4 ft. Hinged Overhang w/LVL Headers & 2x6 Rafters - <b>Listed Price + \$1,000 labor</b>	\$110.00	Chew Guard For 12' Stall	\$575.00
Lineal Ft.-4 ft. overhang w/ 2x6 Rafters & LVL Headers	\$64.00	Chew Guard For Dutch Door Crossbuck- bottom section only	\$115.00
Lineal Ft. of Building-Upgrade-2x4 Rafters to 2x6 Rafters @ 16" O.C.-Sheds	\$9.00		
Lineal Ft. (2) 9 1/4" LVL Headers-upgrade from 2x6 headers -per lineal ft	\$25.00		
<b>EXTRA DOOR</b>			
Wood Dutch Door-48"x84" with 20"hinges & whitcomb latch for barns and tackroom	\$575.00		
Wood Service Door- 36"x80" with 20" hinges & Whitcomb latch for Barns and Tackroom	\$450.00		
Roll doors bigger than 4 x 7 w/ hardware-per sq ft of door	\$25.00		
Wood Double Doors 60"x 80" (Height may vary per building) for storage sheds	\$885.00		
Wood Double Doors 72"x80" (Height may vary per building) for storage sheeds	\$900.00		

**All standard options removed will receive 50% off listed price**



# Carolina Storage Solutions

[www.DeliveredBarnsAndSheds.com](http://www.DeliveredBarnsAndSheds.com)

## Metal Roof & Siding Colors



## Shingle Colors



## Paint Colors



## URETHANE STAIN COLORS

Paint & Stain  
by Haley Paint Co.



Caramel



Bronze



Smoke



# Carolina Storage Solutions

[www.DeliveredBarnsAndSheds.com](http://www.DeliveredBarnsAndSheds.com)  
877-305-4277

# Carolina Storage Solutions - OPTIONS - [www.DeliveredBarnsAndSheds.com](http://www.DeliveredBarnsAndSheds.com)



28"x24" Standard Window  
Slides horizontally



24"x36" Aluminum Window  
Single-hung/Screened



28"x48" Single-Hung Wood Sash Window



36"x24" Drop Vent - Closed -

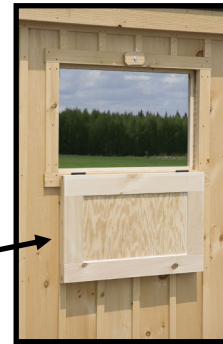

36"x24" Drop Vent - Open -



Gable Vent



20" Cupola w/ Horse Weathervane



4'x7' Dutch Door

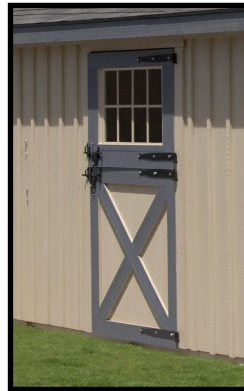

36"x80" Wood Service Door



4'x7' Dutch Door w/ Window



Interior view of tack room



Interior view of 28"x24" standard window w/ metal grill

Service Door With Tempered Glass

## PERSONALIZE



Chew guard in stall

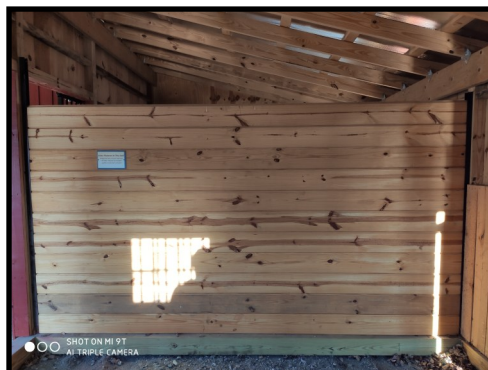

Removable partition wall

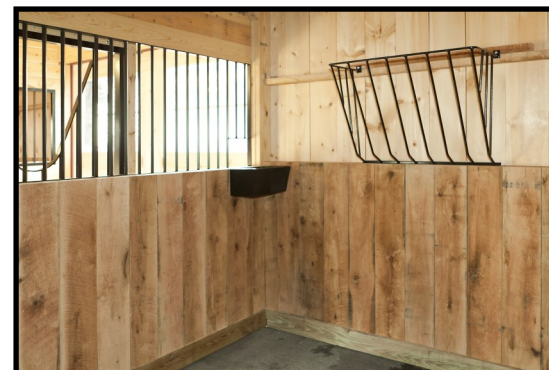

3' Wall mounted hayrack w/ feed hole in grill

## CUSTOMIZE



SYP Kickboard - Floor to ceiling



Tempered Glass In Aisle Doors



Transom Windows in Aisle Doors



Sliding stall door w/ yoke in door

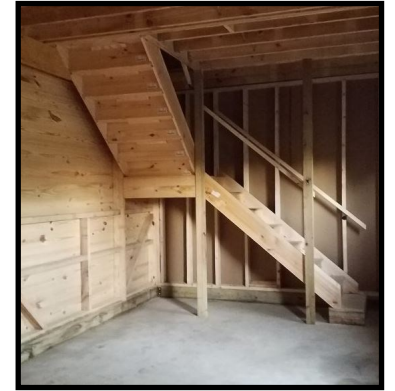

L-Shape Stairs To Loft



Single Sliding Door Above Center Aisle



Double Sliding Doors Above Center Aisle



Wash Stall - Moisture Board on Walls - Shown With Window



Powder Coated Ladder to Loft

