



**Carolina
Storage
Solutions**

www.DeliveredBarnsAndSheds.com

Many sizes and
options to customize
your barn!

Monitor Modular Barn



CUSTOMIZE YOUR BARN - shown with one lean to



CUSTOMIZE YOUR BARN - shown with two lean to's



36x24 Monitor Barn

- 4) 12x12 stalls, tack rooms, or open areas - your choice of layout
- 12x24 Center aisle & 12x24 Loft
- Painted siding and trim
- 20" Cupola
- **We deliver nationwide!** Listed price includes delivery and installation within 50 miles of Tryon, NC. **Call for details!**

\$67,400.00



36x36 Monitor Barn

- 6) 12x12 stalls, tack rooms, or open areas - your choice of layout
- 12x36 Center aisle & 12x36 Loft
- Painted siding and trim
- 20" Cupola
- **We deliver nationwide!** Listed price includes delivery and installation within 50 miles of Tryon, NC. **Call for details!**

\$89,000.00

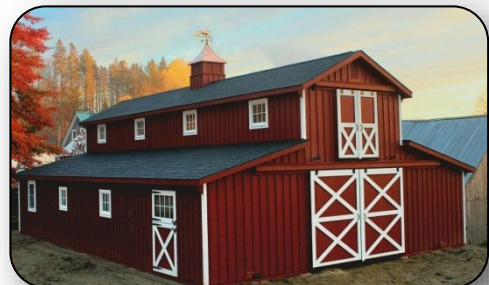

36x48 Monitor Barn

- 8) 12x12 stalls, tack rooms, or open areas - your choice of layout
- 12x48 Center aisle & 12x48 Loft
- Painted siding and trim
- 20" Cupola
- **We deliver nationwide!** Listed price includes delivery and installation within 50 miles of Tryon, NC. **Call for details!**



\$106,400.00

We deliver our barns nationwide! Call 877-305-4277

STANDARD FEATURES

- **MODULAR** - comes in three pieces
- Accelerated onsite installation time
- 6x6 Pressure treated base rail
- Rough sawn oak framing
- Rough sawn pine board & batten siding
- SYP T&G stall fronts w/ grills
- Set of sliding doors in each end of aisle
- 1) sliding stall door and window per stall
- 4' Oak kick boards in stalls
- Loft above aisle with powder-coated ladder to loft
- One window per stall in loft and one service door in loft
- Architectural shingles - 30 year warranty
- No stain or paint on exterior (optional)
- Free preliminary drawings of your barn!

Modular Barn Option Sheet - CAROLINA STORAGE SOLUTIONS - 877-305-4277 - www.DeliveredBarnsAndSheds.com

Description		COST	Description		COST	
ROLL DOORS			STAIRS			
10x10 Roll Door w ith Track & Hardw are		\$2,290.00	36" Wide Stairs With Electric Lift		\$5,715.00	
8x8 Roll Door w ith Track & Hardw are		\$1,470.00	36" Wide Stairs to Loft		\$1,525.00	
6x8 Roll Door w ith Track & Hardw are		\$1,100.00	22"x54" Heavy Duty Pull Dow n Attic Stairs		\$860.00	
6x9 Roll Door w ith Track & Hardw are		\$1,240.00	L Shaped Stairs		\$2,540.00	
5x9 Roll Door w ith Track & Hardw are		\$1,030.00	WASH STALL			
5x8 Roll Door w ith Track & Hardw are		\$915.00	White Glass Board on Walls in 10x10 to 12x12 Wash Stall		\$2,860.00	
4x7 Roll Door w ith Track & Hardw are		\$645.00	CUPOLA			
Wood Sliding Stall Door w / w ood X		\$1,525.00	Cupola - #B-20 Boston Series		\$675.00	
Sliding Stall Door With Grill & Steel X		\$1,780.00	Cupola - #B-24 Boston Series		\$780.00	
Sliding Stall Door With Grill (Standard Door)		\$1,050.00	Cupola - #B-27 Boston Series		\$1,190.00	
Yoke in Stall Door Opening		\$290.00	Cupola - #B-32 Boston Series		\$1,515.00	
Hinged Yoke In Stall Door		\$540.00	Cupola - #B-37 Boston Series		\$1,845.00	
<div style="display: flex; justify-content: space-around;"> <div style="text-align: center;"> <p>Standard Stall Door</p>  </div> <div style="text-align: center;"> <p>Steel X Door</p>  </div> <div style="text-align: center;"> <p>Wood X Door</p>  </div> </div>			Cupola - #B-48 Boston Series		\$3,050.00	
				Weather Vane - Patchen Horse (Polished)		\$505.00
				KICK BOARD		
			Southern Yellow Pine Kickboard Floor to Ceiling (per sq. ft. stall)		\$7.00	
			Southern Yellow Pine 4' high-Upgrade from Oak (per sq. ft. of Stall)		\$3.20	
			ROOFING			
			Insulated Metal Roof per Sq. Ft. of roof		\$4.45	
			EXTRA WINDOWS			
			Extra Window -28"x24" 6 Lite Barn Sash Window		\$160.00	
EXTRA DOORS			Extra Window w /Grill - 28"x24" 6 Lite Barn Sash Window		\$470.00	
4x7 Wood Dutch Door		\$575.00	Thermal - Tempered Window - Dutch Door w / Grill		\$470.00	
4x7 Aluminum Dutch Door		\$2,035.00	Thermal - Tempered Window - Service Door		\$255.00	
Insulated Solid 36"x80" Service Door		\$635.00	Window in Center Aisle Roll Door- Thermal - Tempered Glass		\$585.00	
Insulated 36"x80" Service Door w / 9 Lite Window		\$865.00	Drop Vent - 24"x36" - Hinged on bottom		\$225.00	
36"x80" Wood Service Door		\$455.00				
LEAN TO END CAPS			Sealed Architectural Prints - Shed Row and Run-In Sheds			
8' Lean To End Cap Material Package (not installed)		\$815.00	Sealed Architectural Prints - Modular barns up to \$50,000			
10' Lean To End Cap Material Package (not installed)		\$1,020.00	Sealed Architectural Prints - Modular barns \$50,000 - \$125,000			
12' Lean To End Cap Material Package (not installed)		\$1,220.00	Sealed Architectural Prints - Modular barns \$125,000 and up			

Metal Roof & Siding Colors



Shingle Colors



Paint Colors



URETHANE STAIN COLORS

Paint & Stain
by Haley Paint Co.



Caramel



Bronze



Smoke



Carolina Storage Solutions

www.DeliveredBarnsAndSheds.com
877-305-4277

Carolina Storage Solutions - OPTIONS - www.DeliveredBarnsAndSheds.com

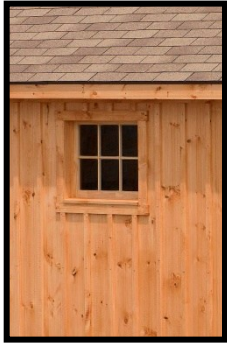

28"x24" Standard Window
Slides horizontally



24"x36" Aluminum Window
Single-hung/Screened



28"x48" Single-Hung Wood Sash Window



36"x24" Drop Vent - Closed -

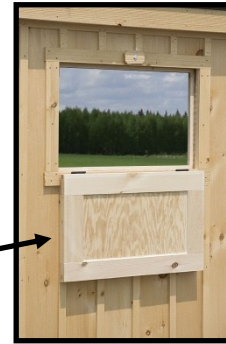

36"x24" Drop Vent - Open -



Gable Vent



20" Cupola w/ Horse Weathervane



4'x7' Dutch Door

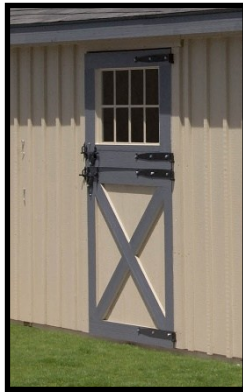

4'x7' Dutch Door w/ Window



Service Door With Tempered Glass



Interior view of tack room



Interior view of 28"x24" standard window w/ metal grill

PERSONALIZE

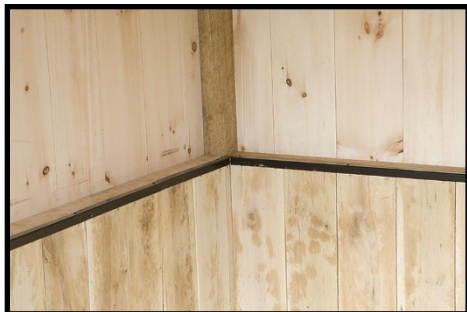

Chew guard in stall

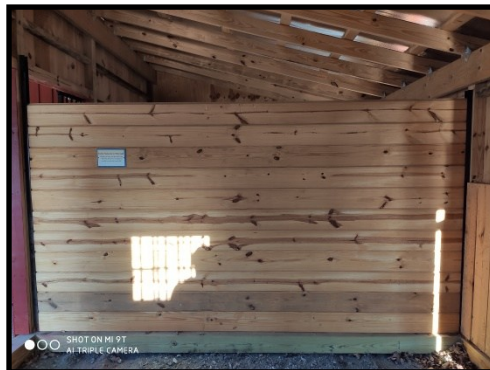

Removable partition wall



3' Wall mounted hayrack w/ feed hole in grill

CUSTOMIZE



SYP Kickboard - Floor to ceiling



Tempered Glass In Aisle Doors



Transom Windows in Aisle Doors



Sliding stall door w/ yoke in door

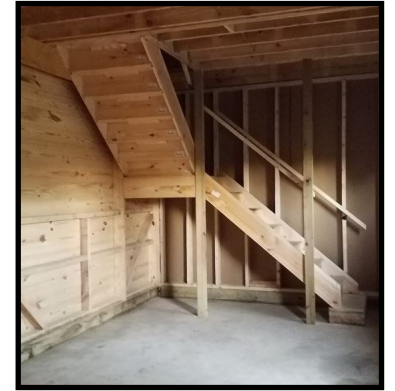

L-Shape Stairs To Loft



Single Sliding Door Above Center Aisle



Double Sliding Doors Above Center Aisle



Wash Stall - Moisture Board on Walls - Shown With Window



Powder Coated Ladder to Loft



**Carolina
Storage
Solutions**

www.DeliveredBarnsAndSheds.com