

Shed Row Horse Barn w/ Lean To

Many sizes and options to
customize your barn!
Call today: 877-305-4277



STANDARD FEATURES:

- 6x6 Pressure treated base rail
- Rough sawn oak framing
- Rough sawn pine board & batten siding
- 10' or 12' Lean to is built on site
- 4' Oak kick boards in stalls
- Dutch door and window in each stall
- Full floor, service door, and one window in tack room
- Lifetime warranty architectural shingles
- No stain or paint on exterior (optional)
- **Your choice:** Solid divider wall or 4' wall with 2' metal grill between stalls and tack room



12x24 Shed Row Barn w/ 12x24 Lean To

Price includes:

- Two 12x12 stalls with one dutch door and one window in each stall
- Painted siding and trim
- FREE 20" Cupola
- Delivered and installed to Tryon, NC

\$23,100.00



12x36 Shed Row Barn w/ 12x36 Lean To

Price includes:

- Two 12x12 stalls with one dutch door and one window in each stall + one 12x12 tack room (or three stalls for the same money)
- Painted siding and trim
- FREE 20" Cupola
- Delivered and installed to Tryon, NC

\$34,200.00



12x48 Shed Row Barn w/ 12x48 Lean To

Price includes:

- Three 12x12 stalls with one dutch door and one window in each stall + one 12x12 tack room (or four stalls for the same money)
- Painted siding and trim
- FREE 20" Cupola
- Delivered and installed to Tryon, NC

\$42,500.00



We deliver our barns nationwide! Call 877-305-4277

Shed Row Barn sizes include the following stall/tack room combinations:

10' WIDE BARN

10x10	one 10x10 stall	10x34	two 10x12 stalls; one 10x10 storage
10x12	one 10x12 stall	10x36	three 10x12 stalls
10x14	one 10x14 stall		two 10x12 stalls; one 10x12 storage
10x16	one 10x10 stall; one 6x10 storage	10x38	three 10x10 stalls; one 8x10 storage
10x18	one 10x10 stall; one 8x10 storage	10x40	four 10x10 stalls
10x20	two 10x10 stalls		three 10x10 stalls; one 10x10 storage
	one 10x10 stall; one 10x10 storage		two 10x10 stalls; one 10x12 stall; one 8x10 storage
	one 10x12 stall; one 8x10 storage		two 10x12 stalls; one 10x10 stall; one 6x10 storage
10x22	one 10x12 stall; one 10x10 stall	10x42	three 10x10 stalls; one 10x12 stall
	one 10x12 stall; one 10x10 storage		three 10x10 stalls; one 10x12 storage
10x24	two 10x12 stalls		three 10x12 stalls; one 6x10 storage
	one 10x12 stall; one 10x12 storage		two 10x10 stalls; one 10x12 stall; one 10x10 storage
10x26	two 10x10 stalls; one 6x10 storage		two 10x12 stalls; one 10x10 stall; one 8x10 storage
10x28	two 10x10 stalls; one 8x10 storage	10x44	three 10x12 stalls; one 8x10 storage
10x30	three 10x10 stalls		two 10x10 stalls; two 10x12 stalls
	two 10x10 stalls; one 10x10 storage	10x46	three 10x12 stalls; one 10x10 storage
	two 10x12 stalls; one 6x10 storage		three 10x12 stalls; one 10x10 stall
10x32	two 10x12 stalls; one 8x10 storage	10x48	four 10x12 stalls
			three 10x12 stalls; one 10x12 storage

12' WIDE BARN

12x12	one 12x12 stall	12x30	three 10x12 stalls
12x14	one 12x14 stall		two 10x12 stalls; one 10x12 storage
12x16	one 10x12 stall; one 6x12 storage		two 12x12 stalls; one 6x12 storage
12x18	one 12x12 stall; one 6x12 storage	12x32	two 12x12 stalls; one 8x12 storage
	one 10x12 stall; one 8x12 storage	12x34	two 12x12 stalls; one 10x12 storage
12x20	one 12x12 stall; one 8x12 storage	12x36	three 12x12 stalls
	two 10x12 stalls		two 12x12 stalls; one 12x12 storage
	one 10x12 stall; one 10x12 storage	12x38	three 10x12 stalls; one 8x12 storage
12x22	one 12x12 stall; one 10x12 storage	12x40	four 10x12 stalls
	one 12x12 stall; one 10x12 stall		three 10x12 stalls; one 10x12 storage
12x24	two 12x12 stalls	12x42	three 12x12 stalls; one 6x12 storage
	one 12x12 stall; one 12x12 storage	12x44	three 12x12 stalls; one 8x12 storage
12x26	two 10x12 stalls; one 6x12 storage	12x46	three 12x12 stalls; one 10x12 storage
12x28	two 10x12 stalls; one 8x12 storage		three 12x12 stalls; one 10x12 stall
		12x48	four 12x12 stalls
			three 12x12 stalls; one 12x12 storage



Inside of stall - Kick board and window with metal grill; No floor

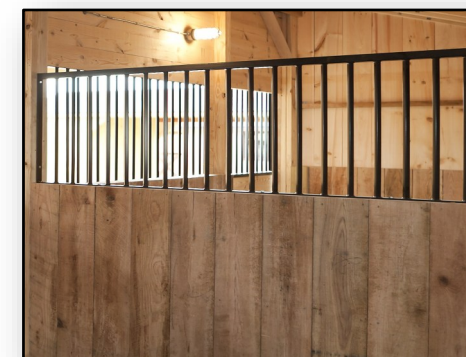

ABOVE: 4' wall with 2' metal grill
BELOW: Solid divider wall

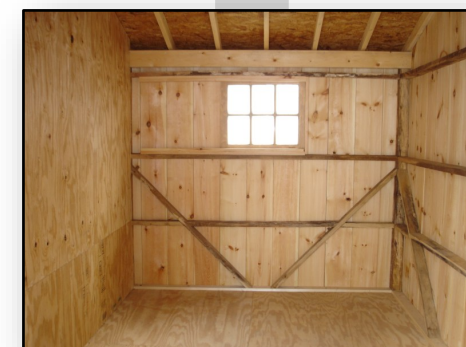

Inside of tack room - One window, full floor, and solid divider wall

RUN-IN SHEDS, SHED ROW BARNs, & STORAGE SHEDS OPTIONS

ROOF OPTIONS	COST	EXTRA WINDOWS	COST
15 lbs. felt roof underlayment-per sq ft	\$0.95	Shutters- wooden with Z brace- (2) per window	\$180.00
Ice & Water Sheild roof underlayment- per square ft of roof	\$1.85	Window -Service Door w ith Thermal Tempered Glass - per w indow	\$255.00
29 Ga. Metal roof w/double bubble insulation-instead of std shingle roof-per sq fto of roof	\$4.45	Window -Dutch Door w ith Thermal Tempered Glass and grill-per w indow	\$475.00
Upgrade 1/2" Plywood instead of std OSB -per sq ft of roof	\$0.65	28"x24" 6 Lite Wood Barn Sash Window	\$160.00
Custom Roof Colors and Brands - call for quote		28"x24" 6 Lite Wood Barn Sash Window w/grill-per window	\$470.00
Custom Paint or Stain Colors or Brands add 20% to base price		5' & 6' Transom Window in or above Storage Shed Doors	\$165.00
Gable Vent- 19"x28" overall, screened vented area 12"x22"	\$180.00	10"x29" Transom Window in Service Door	\$110.00
Ridge Vent- per lineal ft	\$9.50	Drop Vent- 24"X36" hinged on bottom	\$225.00
KICK BOARD		CUPOLA	
Kickboard Southern Yellow Pine 2x8 T&G 4' high in stall upgrade per sq ft of stall	\$3.20	B-20 Boston Series	\$675.00
Kickboard Southern Yellow Pine 2x8 T&G 8' high in stall upgrade per sq ft of stall	\$7.00	B-24 Boston Series	\$910.00
		Weather Vane-Patchen Horse (Polished)	\$500.00
PARTITION ADDED RUN IN SHED		Cupola-Screened on inside of louvers-per cupola	\$115.00
Partition Addition-8' wide with grill or optinal removable partition with 2x8 T&G 7' high	\$635.00	Cupola-Chimney vented & flashed-Check for price	
Partition addition-10' Wide Grill Partition or optional removable Partition with 2x8 T&G 7' high	\$795.00		
Partition Addition-12' Wide Grill Partition or optional Removable Partition with 2x8 T&G 7' high	\$955.00	STORAGE SHED DOORS	
Grill Mounted Hay Rack & Feed Hole in Grill	\$215.00	Wider Doors 6' Wide-height may vary per style of building	\$65.00
3' Wall Mounted Hayrack	\$180.00	Wider Doors 8' Wide-height may vary per style of building	\$100.00
8' Wire-Filled Horse Gate w/ Lockable Latch	\$425.00		
		STORAGE ROOM FLOOR	
STORAGE ROOM RUN IN SHED		Sq. Ft. of Floor-Floor Joist @ 12" O.C.	\$1.05
Storage Room- Run In Shed-8' wide	\$1,245.00	Sq. Ft. of Floor-Floor Joist @ 8" O.C.	\$1.50
Storage Room-Run In Shed-10' Wide	\$1,405.00	Sq. Ft. of Floor-Upgrade-Pressure Treated Plywood or Advantech	\$1.30
Storage Room-Run In Shed-12' Wide	\$1,565.00		
		CHEW GUARDS	
OTHER OPTIONS		Chew Guard For 10' Stall	\$535.00
Lineal Ft.-4 ft. Hinged Overhang w/LVL Headers & 2x6 Rafters - Listed Price + \$1,000 labor	\$110.00	Chew Guard For 12' Stall	\$575.00
Lineal Ft.-4 ft. overhang w/ 2x6 Rafters & LVL Headers	\$64.00	Chew Guard For Dutch Door Crossbuck- bottom section only	\$115.00
Lineal Ft. of Building-Upgrade-2x4 Rafters to 2x6 Rafters @ 16" O.C.-Sheds	\$9.00		
Lineal Ft. (2) 9 1/4" LVL Headers-upgrade from 2x6 headers -per lineal ft	\$25.00		
EXTRA DOOR			
Wood Dutch Door-48"x84" with 20"hinges & whitcomb latch for barns and tackroom	\$575.00		
Wood Service Door- 36"x80" with 20" hinges & Whitcomb latch for Barns and Tackroom	\$450.00		
Roll doors bigger than 4 x 7 w/ hardware-per sq ft of door	\$25.00		
Wood Double Doors 60"x 80" (Height may vary per building) for storage sheds	\$885.00		
Wood Double Doors 72"x80" (Height may vary per building) for storage sheeds	\$900.00		



All standard options removed will receive 50% off listed price



Carolina Storage Solutions

www.DeliveredBarnsAndSheds.com

Modular Barn Option Sheet - CAROLINA STORAGE SOLUTIONS - 877-305-4277 - www.DeliveredBarnsAndSheds.com

Description		COST	Description		COST	
ROLL DOORS			STAIRS			
10x10 Roll Door w ith Track & Hardw are		\$2,290.00	36" Wide Stairs With Electric Lift		\$5,715.00	
8x8 Roll Door w ith Track & Hardw are		\$1,470.00	36" Wide Stairs to Loft		\$1,525.00	
6x8 Roll Door w ith Track & Hardw are		\$1,100.00	22"x54" Heavy Duty Pull Dow n Attic Stairs		\$860.00	
6x9 Roll Door w ith Track & Hardw are		\$1,240.00	L Shaped Stairs		\$2,540.00	
5x9 Roll Door w ith Track & Hardw are		\$1,030.00	WASH STALL			
5x8 Roll Door w ith Track & Hardw are		\$915.00	White Glass Board on Walls in 10x10 to 12x12 Wash Stall		\$2,860.00	
4x7 Roll Door w ith Track & Hardw are		\$645.00	CUPOLA			
Wood Sliding Stall Door w / w ood X		\$1,525.00	Cupola - #B-20 Boston Series		\$675.00	
Sliding Stall Door With Grill & Steel X		\$1,780.00	Cupola - #B-24 Boston Series		\$780.00	
Sliding Stall Door With Grill (Standard Door)		\$1,050.00	Cupola - #B-27 Boston Series		\$1,190.00	
Yoke in Stall Door Opening		\$290.00	Cupola - #B-32 Boston Series		\$1,515.00	
Hinged Yoke In Stall Door		\$540.00	Cupola - #B-37 Boston Series		\$1,845.00	
<div style="display: flex; justify-content: space-around;"> <div style="text-align: center;"> <p>Standard Stall Door</p>  </div> <div style="text-align: center;"> <p>Steel X Door</p>  </div> <div style="text-align: center;"> <p>Wood X Door</p>  </div> </div>			Cupola - #B-48 Boston Series		\$3,050.00	
				Weather Vane - Patchen Horse (Polished)		\$505.00
				KICK BOARD		
			Southern Yellow Pine Kickboard Floor to Ceiling (per sq. ft. stall)		\$7.00	
			Southern Yellow Pine 4' high-Upgrade from Oak (per sq. ft. of Stall)		\$3.20	
			ROOFING			
			Insulated Metal Roof per Sq. Ft. of roof		\$4.45	
			EXTRA WINDOWS			
			Extra Window -28"x24" 6 Lite Barn Sash Window		\$160.00	
EXTRA DOORS			Extra Window w /Grill - 28"x24" 6 Lite Barn Sash Window		\$470.00	
4x7 Wood Dutch Door		\$575.00	Thermal - Tempered Window - Dutch Door w / Grill		\$470.00	
4x7 Aluminum Dutch Door		\$2,035.00	Thermal - Tempered Window - Service Door		\$255.00	
Insulated Solid 36"x80" Service Door		\$635.00	Window in Center Aisle Roll Door- Thermal - Tempered Glass		\$585.00	
Insulated 36"x80" Service Door w / 9 Lite Window		\$865.00	Drop Vent - 24"x36" - Hinged on bottom		\$225.00	
36"x80" Wood Service Door		\$455.00				
LEAN TO END CAPS			Sealed Architectural Prints - Shed Row and Run-In Sheds			
8' Lean To End Cap Material Package (not installed)		\$815.00	Sealed Architectural Prints - Modular barns up to \$50,000			
10' Lean To End Cap Material Package (not installed)		\$1,020.00	Sealed Architectural Prints - Modular barns \$50,000 - \$125,000			
12' Lean To End Cap Material Package (not installed)		\$1,220.00	Sealed Architectural Prints - Modular barns \$125,000 and up			

Metal Roof & Siding Colors



Shingle Colors



Paint Colors



URETHANE STAIN COLORS

Paint & Stain
by Haley Paint Co.



Caramel



Bronze



Smoke



Carolina Storage Solutions

www.DeliveredBarnsAndSheds.com
877-305-4277

Carolina Storage Solutions - OPTIONS - www.DeliveredBarnsAndSheds.com



28"x24" Standard Window
Slides horizontally



24"x36" Aluminum Window
Single-hung/
Screened



28"x48" Single-Hung Wood Sash Window



36"x24" Drop Vent - Closed -

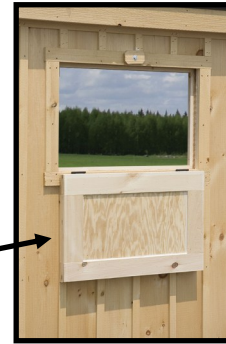

36"x24" Drop Vent - Open -



Gable Vent



20" Cupola w/
Horse Weathervane



4'x7' Dutch Door



36"x80" Wood Service Door



4'x7' Dutch Door w/
Window



Interior view of tack room



Interior view of 28"x24" standard window w/
metal grill

Service Door With Tempered Glass

PERSONALIZE



Chew guard in stall

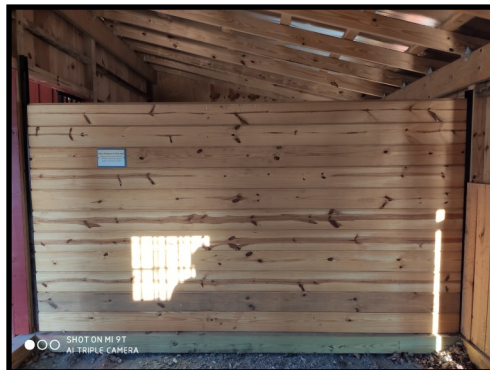

Removable partition wall



3' Wall mounted hayrack w/
feed hole in grill

CUSTOMIZE



SYP Kickboard - Floor to ceiling



Tempered Glass In Aisle Doors



Transom Windows in Aisle Doors



Sliding stall door w/ yoke in door

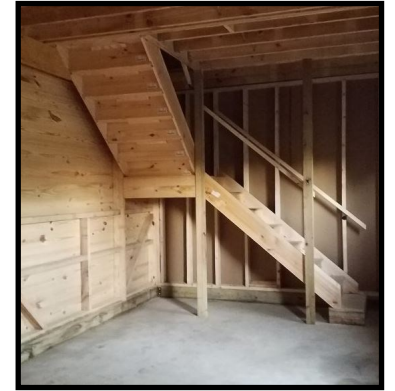

L-Shape Stairs To Loft



Single Sliding Door Above Center Aisle



Double Sliding Doors Above Center Aisle



Wash Stall - Moisture Board on Walls - Shown With Window



Powder Coated Ladder to Loft

